

BAN020C

FM Two Dipoles Panel

87.5÷108 MHz

Type	BAN020C
ELECTRICAL	
Frequency	87.5÷108 MHz
Impedance	50 Ω unbalanced
V.S.W.R. (R.L)	< 1.15 (-23.1 dB)
Gain	7.0 dBd
HPBW H-pattern	± 31°
HPBW V-pattern	± 36°
Polarization	Vertical
Max power	See Below Table
Input connector	7/16 (f) din , 7/8" EIA
Lightning Protection	DC grounded
MECHANICAL	
Connector material	Nickel plated Brass
External parts material (Screen)	Hot Dip galvanized Steel
External parts material (Dipoles)	Passivated Stainless Steel
Internal lines material	Silver plated Aluminum
Insulators material	Virgin PTFE
Mounting Hardware material	Stainless Steel
Pressurization	yes
Environment Protection	U.V. resistant Fiberglass Radome*
Survival wind velocity	240 km/h
Wind load at 160 km/h Frontal	1600 N
Wind load at 160 km/h Lateral	980 N
Dimensions	200 x 220 x 100 cm
Weight	51.0 kg
Mounting System	See Below

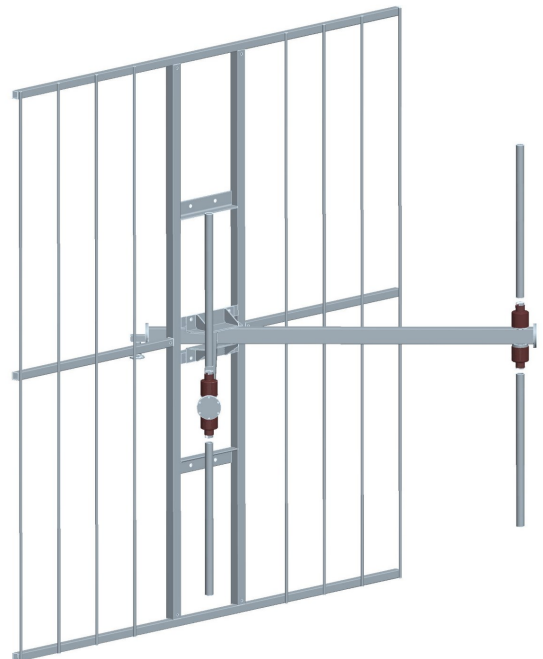

RADIATION PATTERN

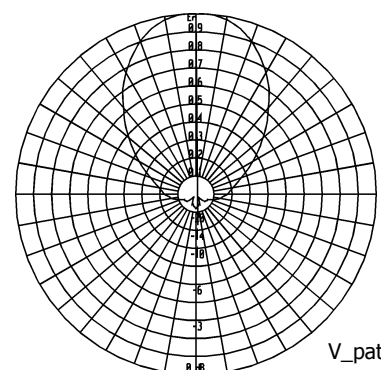
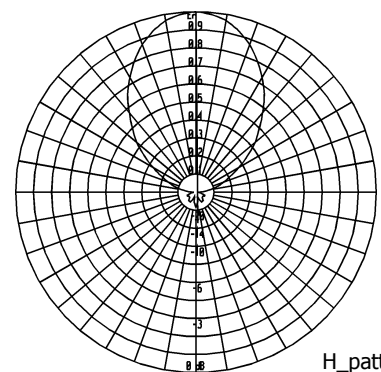

* Order separately

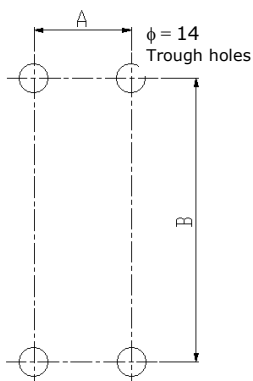

MOUNTING SYSTEM

On frame according to the mounting lay-out beside, where:

- A = 130 mm
- B = 1000 mm
- C = 14 mm

Pole mount available on request.

Ordering Information

p/n	Input Connector	Max Power
BAN020C.01	7/16 (f)	3.5 kW
BAN020C.02	7/8" EIA	5.0 kW